

ADJUSTABLE COLLIMATING ADAPTER

UNIFORMITY OF SPOT SIZES from various light guides

Beam Profiles

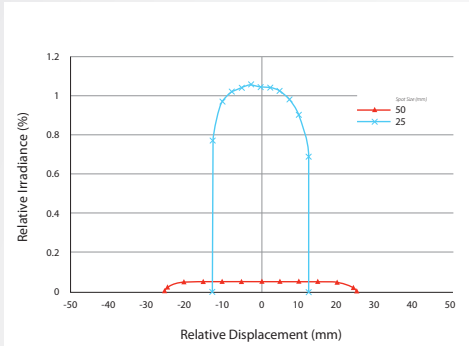

3mm Liquid Light Guide with Adjustable Collimating Adaptor		
SPOT SIZE (mm)	DISTANCE AWAY (cm)	IRRADIANCE mW/cm ²
50	38.20	7.22
25	19.40	135.00

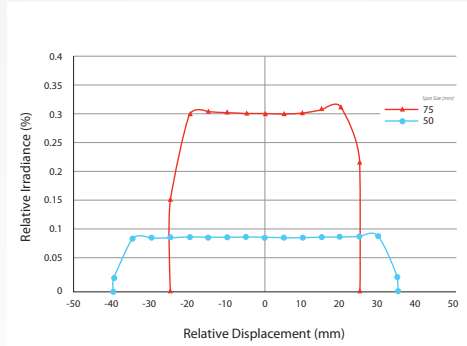

5mm Liquid Light Guide with Adjustable Collimating Adaptor		
SPOT SIZE (mm)	DISTANCE AWAY (cm)	IRRADIANCE mW/cm ²
75	57.02	10.02
50	22.10	70.00

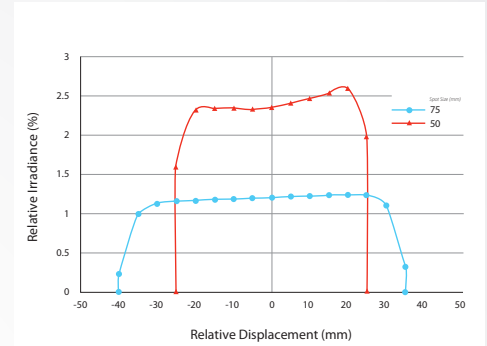

8mm Liquid Light Guide with Adjustable Collimating Adaptor		
SPOT SIZE (mm)	DISTANCE AWAY (cm)	IRRADIANCE mW/cm ²
75	18.80	74.50
50	14.70	184.00

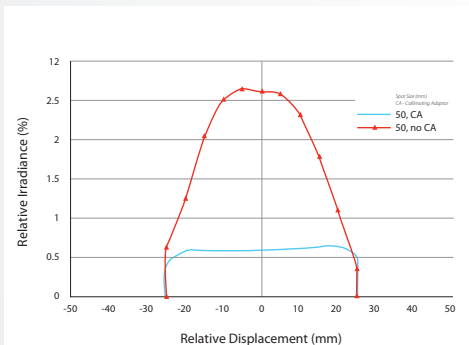

8mm Liquid Light Guide with/without Adjustable Collimating Adaptor		
Spot Size (mm)	DISTANCE AWAY (cm)	IRRADIANCE mW/cm ²
50 (without CA)	3.50	707.00
50 (with CA)	14.70	184.00

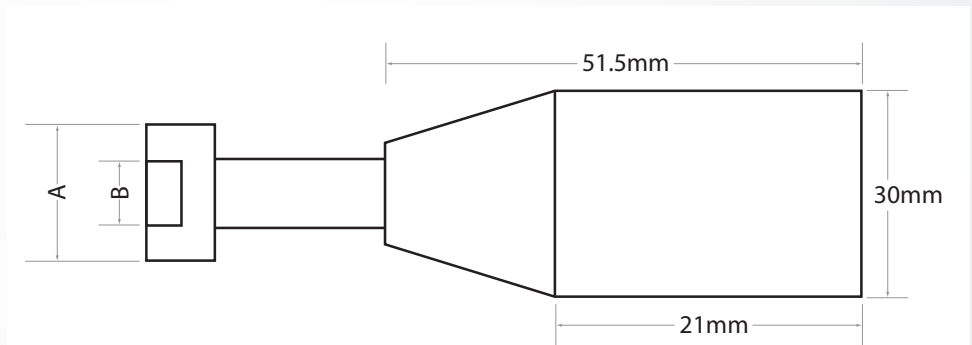

Light Guide Holder Dimensions				
		A	B	C
3mm	mm	17.78	9.25	12.7
	inches	0.70	0.36	0.50
5mm	mm	17.78	10.21	12.7
	inches	0.70	0.40	0.50
8mm	mm	21.59	14.99	13.79
	inches	0.85	0.59	0.54

As you can see, you can achieve a uniform distribution of light by using an Adjustable Collimating Adaptor.

NOTE: All measurements were taken with an LDGI R2000 Cure Site Radiometer.

NOTE: All dimensions are shown in inches and millimeters. Dimensions relate to standard LDGI Adjustable Collimating Adaptors and are for the purpose of providing fixturing and clearance details. Customized solutions are available upon request.

For 3mm, 5mm and 8mm Adjustable Collimating Adaptors, Part Numbers: 810-00041, 810-00042, 810-00043



2260 Argenta Road,
Mississauga, Ontario,
L5N 6H7 CANADA

www.ldgi.com

Telephone: +1 905 821-2600
Toll Free (USA and Canada): +1 800 668-8752
Facsimile: +1 905 821-2055

omnicure@ldgi.com



For a detailed look at our application solutions visit: <http://www.ldgi.com/omnicure/applications/>

Lumen Dynamics Group Inc. is certified under the globally recognized ISO 9001 Quality Management System and the ISO 14001 Environmental Management System. Our global customers can trust that Lumen Dynamics strives to be the best possible supplier in all aspects of our business.

OmniCure®, StepCure® and Intelli-Lamp® are registered trademarks of Lumen Dynamics Group Inc. All rights reserved. Lumen Dynamics has made every effort to ensure that the information contained in this specification sheet is accurate. However, we accept no responsibility for any errors or omissions, and we reserve the right to modify design, characteristics and products at any time without obligation.

Contact Lumen Dynamics for prices and availability or to obtain the phone number of your local Lumen Dynamics representative. No part of this publication may be reproduced, transmitted, transcribed, stored in a retrieval system or translated into any language in any form by any means without the prior written consent of Lumen Dynamics Group Inc.